

# Convenience Store Entrances

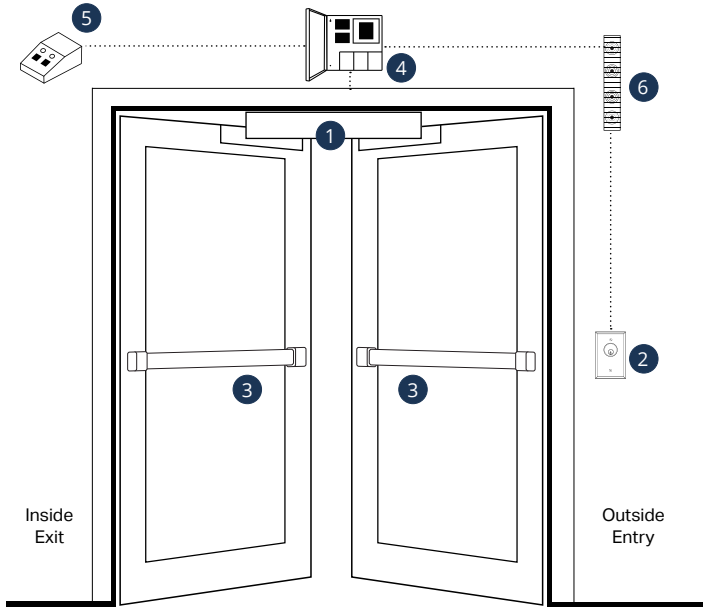

## 1 1510 Series

### Premium Electromagnetic Locks

1511V	Single EMLock
1512V	Double EMLock



- 1,650lb holding force
- Auto-sensing dual voltage
- Interlocking quick mount

## 2 800AL Series

### Vandal Resistant Key Switches

801AL	AA, SPDT, Single Gang
801ALN	AA, SPDT, Narrow
802AL	MO, SPDT, Single Gang



- ¼" thick aluminum faceplates
- Tamper resistant
- 1" - 1 5/8" mortise cylinder compatible

## 3 PSB560 Series

### Pressure Sense Bars

PSB560V36	36" Opening
PSB560V42	42" Opening
PSB560V48	48" Opening



- Tri-failsafe
- Heavy duty aluminum extrusion
- Metal end caps

## 4 631 Series

### 1.5 Amp Power Controllers

631RF	Controller with Cabinet
RB12V4	12V/5Ah Battery
RB12V4-2	12V/5Ah Battery, Qty 2



- Regulated and filtered linear DC power
- Field selectable dual voltage (12/24 VDC)
- Fire/emergency release input

## 5 DT Series

### Mini Desktop Control Consoles

DTMOMA-2	One MO & One MA Switch
DTMO-2	Two MO Switches
DTMO-1	One MO Switch



- Alarm reset and bypass control
- Visual status indicator (LED)
- SPDT contacts

## 6 EA100 Series

### Multi-Mode Visual Annunciators

EA100	ExitAnnunciator
-------	-----------------



- Multi-color LED technology
- Solid or flashing modes
- Easy installation